

1 2 3 4

A

B

C

D

E

F

A

B

C

D

E

F

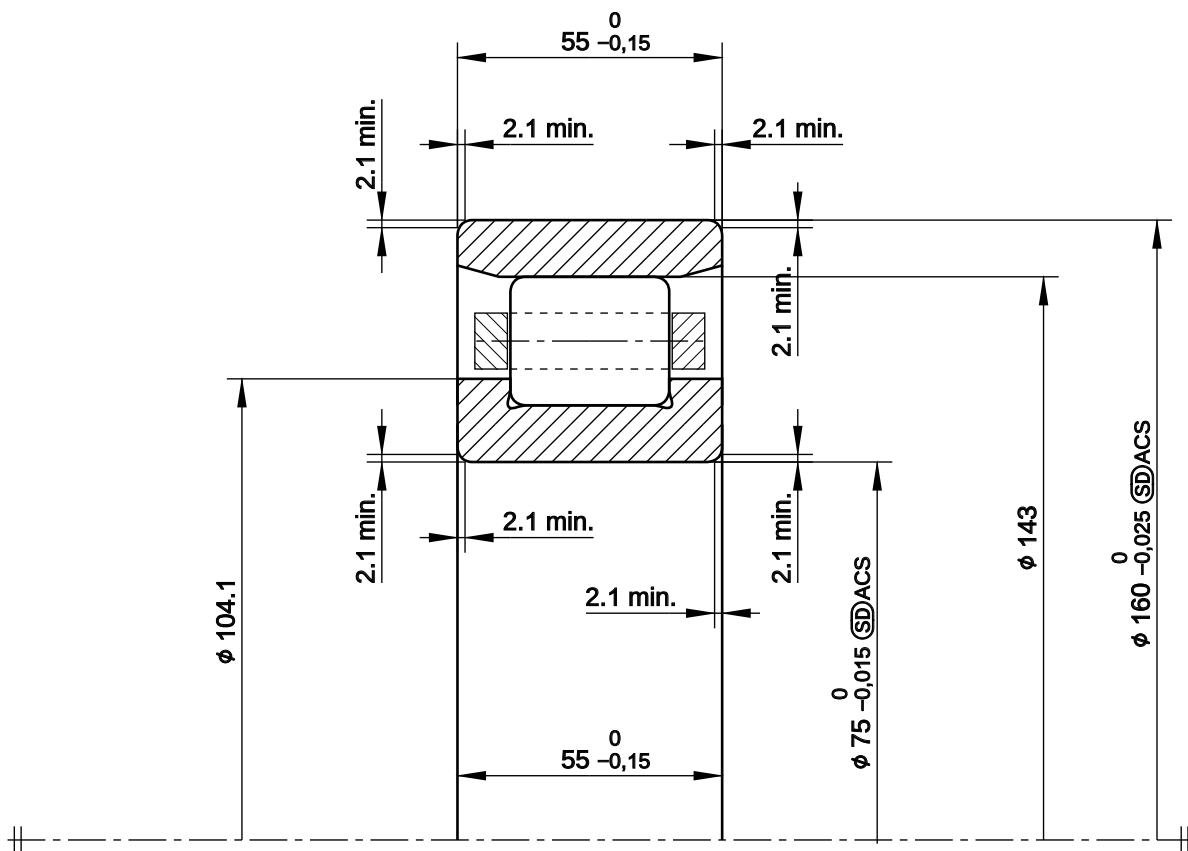

Radial internal clearance acc. to ISO 5753-1 (group 3)
 respectively DIN 620-4 (C3): 0.065 to 0.100
 Cagedesign: solid brass cage
 Verification according to ISO 1132-2

X-life

Load rating [kN]: C _r : 390 C _{0r} : 395 C _{ur} : 73 Speed limit [min ⁻¹]: n _G : 6600 n _B : 3550 acc. to: ISO 15312:2003	Factors: e: 0.00 x1: 1.00 x2: 1.00 y1: 0.00 y2: 0.00 e0: 0.00 x01: 1.00 x02: 1.00 y01: 0.00 y02: 0.00	Tolerances to: ISO 492: 2014 / Tol. class Normal	Scale: none	A4		Weight [kg]: ~ 5,40
Description: Cylindrical roller bearing with cage, single row N2315-E-XL-M1-C3						
© 2016 Schaeffler Technologies AG & Co. KG					Date of Print: 16.01.2020	



FAG

1 2 3 4